

Basketball Hoop

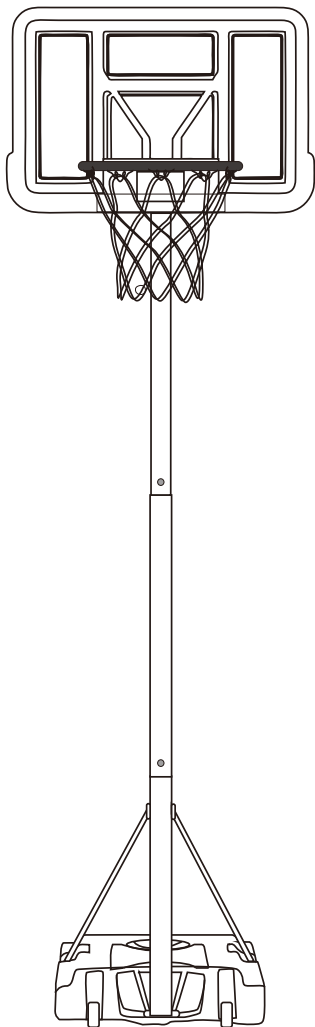

USER MANUAL

Suggestion

- Thank you for choosing our product. To ensure safety, please read the user manual carefully before assembling or using the product. Additionally, follow the instructions for usage, storage, moving, installation, and disassembly to inspect the stability of the base' s counterweight screws, preventing damage to the product. If you pass this product on to third parties, be sure to provide them with these operating instructions.
- It is recommended that 2 or more adults install it. Children and baby are not allowed to install.
- Before use, check whether the base is leaking and whether the screws are tight. If the base is leaking, do not use the base by filling it with water, and please contact customer support.
- The product is suitable for recreation and fitness. Intense and fierce competition. It is forbidden to dunk and hang vigorously.
- After successful installation, the base must be filled with water immediately to prevent it from falling upside down. The base must be placed flat on a level and level ground before use to prevent damage to the base caused by sharp objects or increased use time.
- If the product is used outdoors for a long time, please ensure that the top of the main pole and the lifting pole are covered with plastic covers to prevent rainwater from affecting the product life.
- Please do not wear watches, necklaces, earrings and other jewelry when in use, to prevent hanging up the basket or losing it during exercise.

Warning

- Children are not allowed to install .
- It is forbidden to climb.
- It is forbidden to hang on the hoop, backboard bracket and bead net.
- It is forbidden for children to move the product or adjust the height of the product.
- It is forbidden to use products with potential safety hazards. If there are parts that need to be repaired or replaced, please contact after-sales personnel or local dealers in time.
- Special care must be taken when moving on uneven ground, the product may tip over, causing bodily injury.
- In order to avoid damage to the base due to freezing. when the temperature is lower than 0 degrees Celsius, in the base the water must be poured out.
- When adjusting the height, keep your fingers away from moving parts to avoid finger injuries.



WARNING:
IMPROPER INSTALLATION
OR SWINGING ON THE RING
MAY CAUSE SERIOUS
INJURY OR DEATH

What's Included

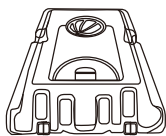

1 x Base
(S)

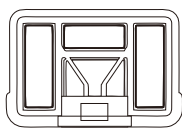

1 x Backboard
(M)



1 x backboard bracket
(K)

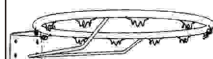

1 x Rim
(J)



1 x Nets
(L)

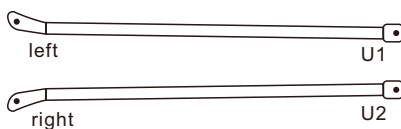

2 x Base support rods



1 x Wheel pin
(O)

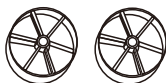

2 x Wheels
(G)

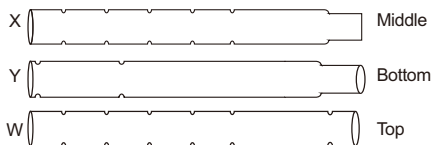

3 x Main poles

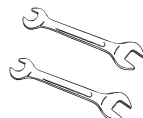

2 x wrenches

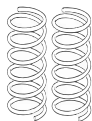

2 x springs

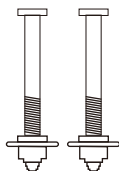

2 x 110mm screws



2 x 16mm screws



2 x 35mm screws

A Bag

B Bag

C Bag

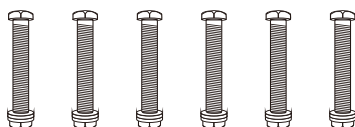

6 x 85mm screws

D Bag



2 x 20mm screws

E Bag



1 x 90mm screw

F Bag

How To Install

How To Use Screws And Wrenchs

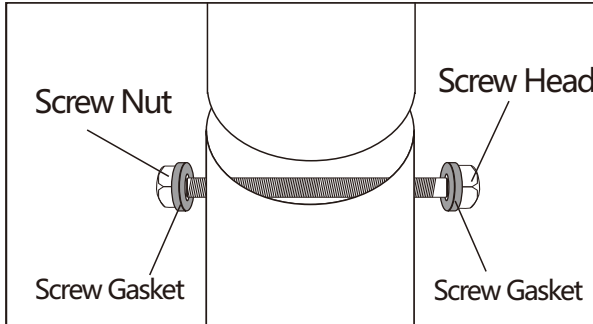

1.Place a screw gasket next to each screw head and a screw gasket next to each screw nut.

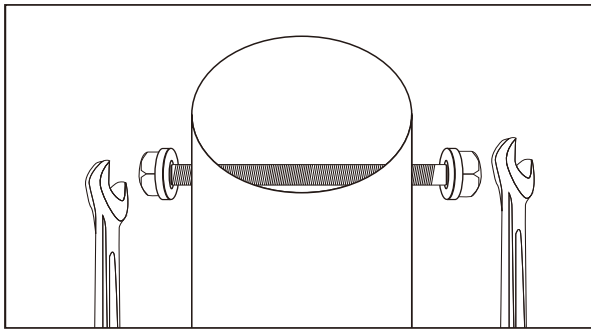

2.Use one hand to clamp the screw head with a wrench, and the other hand to tighten the screw nut with another wrench.

How To Install Basketball Hoop

- 1.Put bottom pole (**Y**) onto the base (**S**) .
- 2.Place the wheel (**G**) into the corresponding hole on the base (**S**) .
- 3.Cross wheel pin (**O**) through the holes that is in the base (**S**) and at the bottom of the bottom pole (**Y**) .

Tip:

When there is a burr at the pipe connection or the pipe end is deformed, a cardboard or wooden board can be placed on the bottom of the lower pipe, and the necked part of the pipe can be knocked.

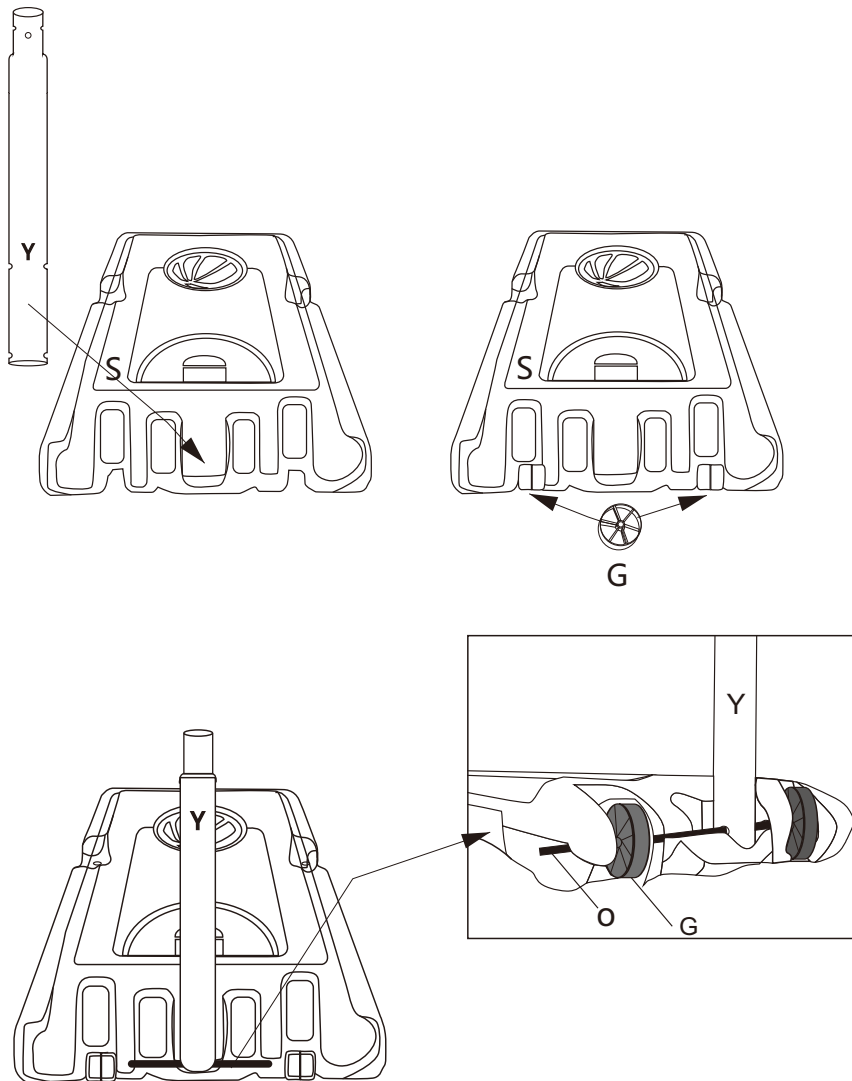

4.Install left base support rod (U1) and right base support rod (U2) onto the base (S), using the screws from the E and F bag.

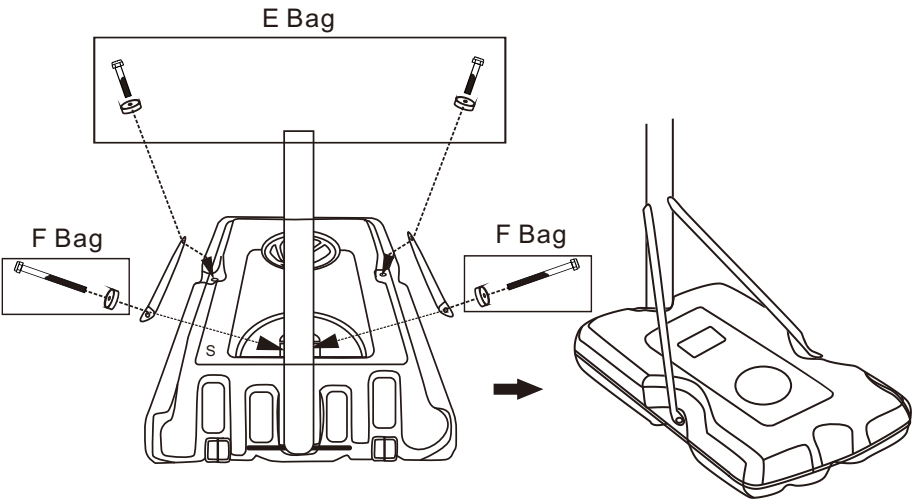

5.Open the cover on the base (S) . Then Pour a little water into the base (S) . And fill the base (S) and close the cover on the base (S) .

Notes:

- 1) If there is any leakage, customer support needs to be contacted.
- 2) If the base is filled with water, but water freezes below 0°C, it is easy to damage the base .

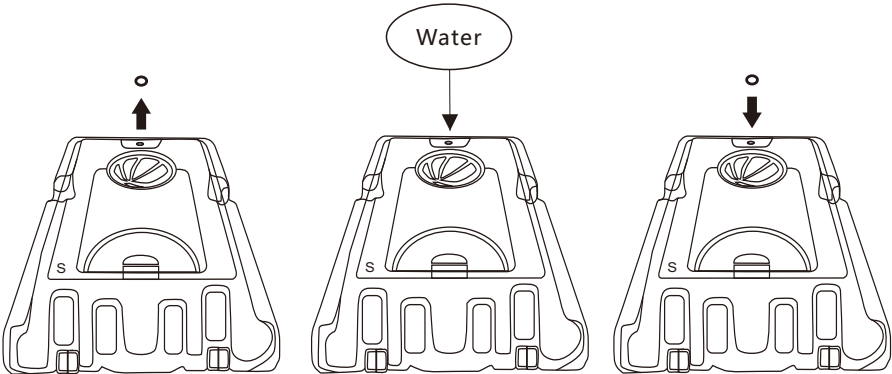

6. Install the middle pole (**X**) onto the bottom pole (**Y**) , using the screws from the **D** bag.

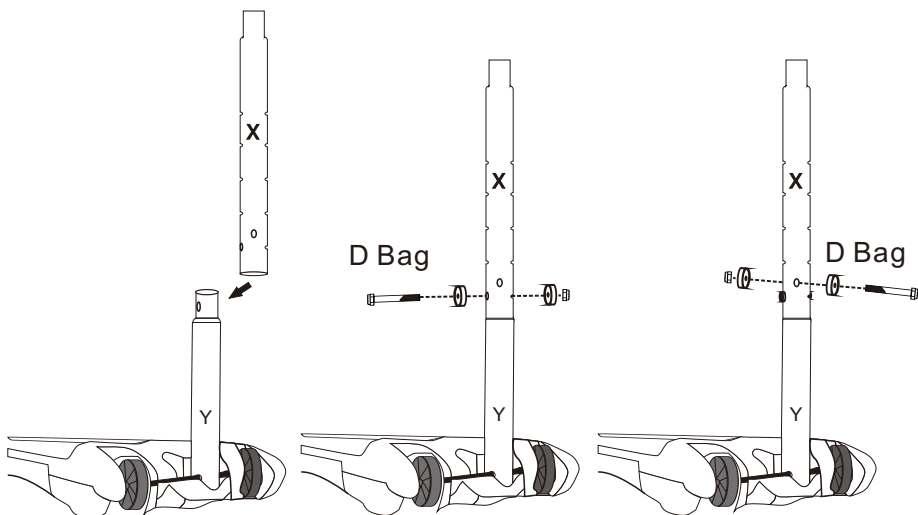

7. Bend the backboard bracket (**K**), and display it as a Y-shaped shape.

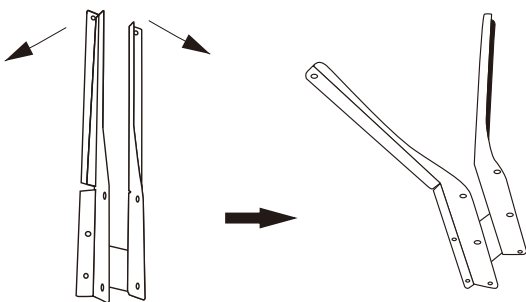

8. Put the rim (**J**) on the front of the backboard (**M**), then tighten the rim (**J**) , backboard (**M**) and the bottom of backboard bracket (**K**), using the screws from the **A** and **C** bag.

9. Put the backboard bracket (**K**) on the back of the backboard (**M**), and tighten the two pipes at the top of backboard bracket (**K**) with the backboard, using the screws from the **B** bag.

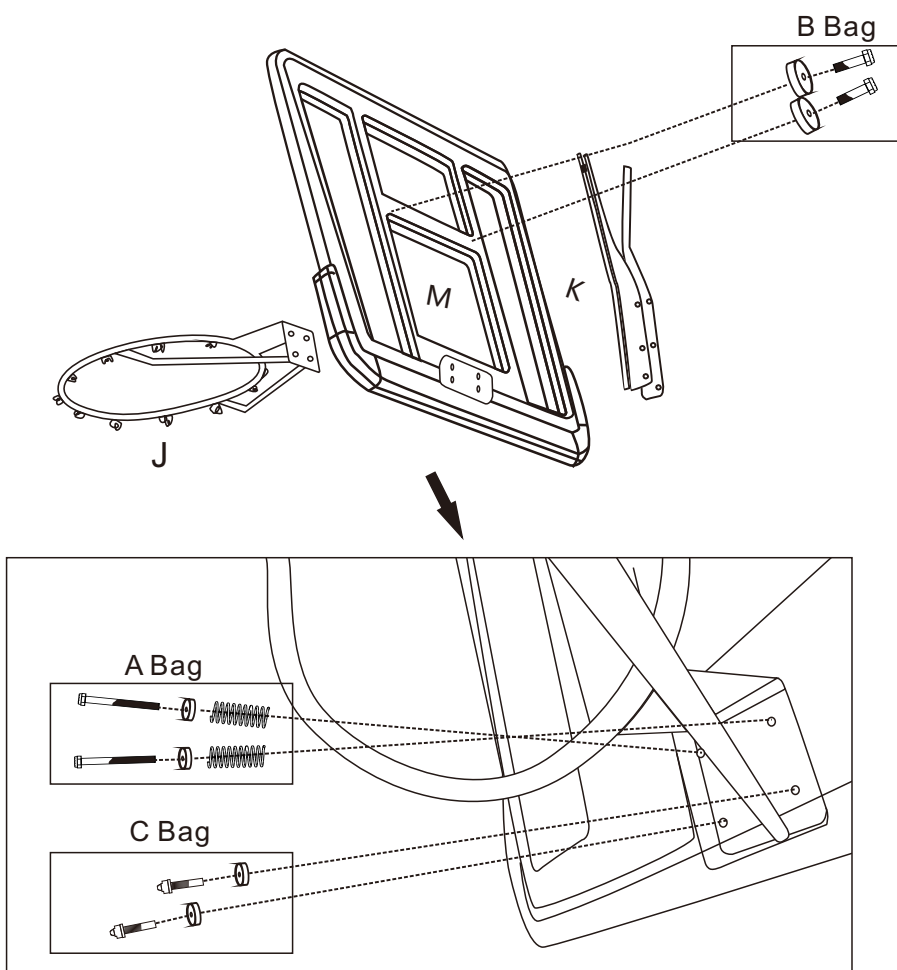

Notes:

The screws in **A** and **C** bag need to penetrate the bottom holes of the rim (**J**), backboard (**M**) and backboard bracket (**K**).

10. Install the top pole (**W**) on the back of the backboard (**M**), using the screws from the **D** bag.

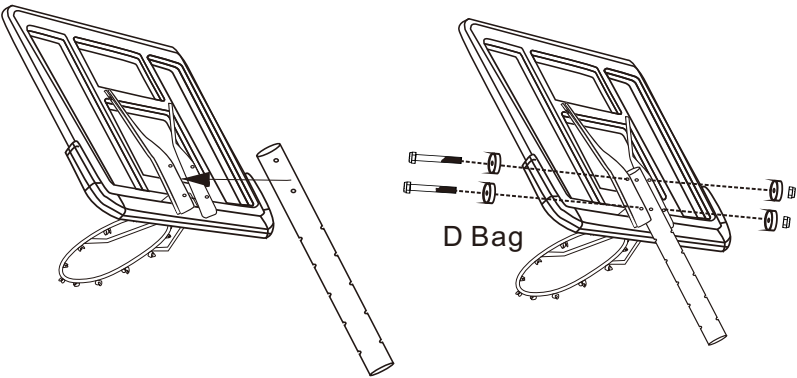

11. Install the Nets (**L**) on the rim (**J**).

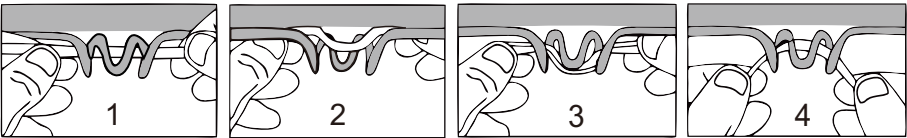

12. Install the top pole (**W**) on the middle pole (**X**), using the screws from the **D** bag. That's it.

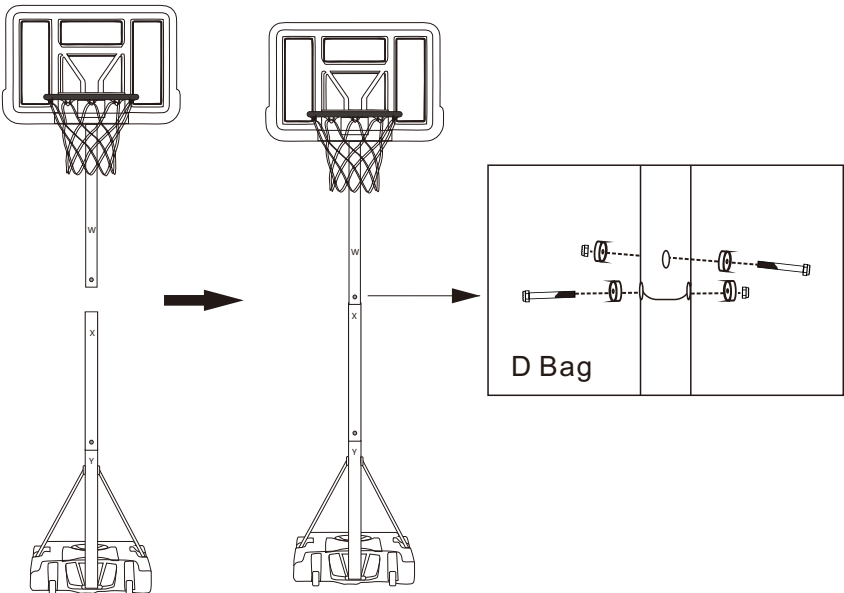

Height Adjustment

1.Lock the backboard (**M**) in different holes on the top pole (**W**) to form different positions.

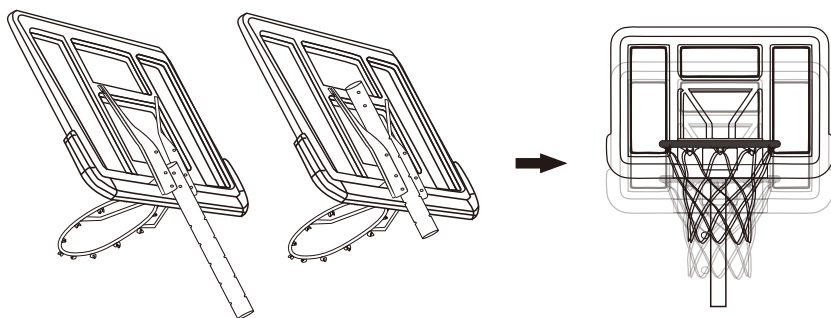

2.Remove the middle pole (**X**), and assemble the top pole (**W**) and bottom pole (**Y**) together.

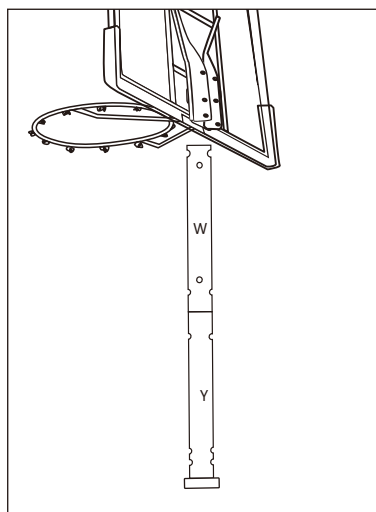
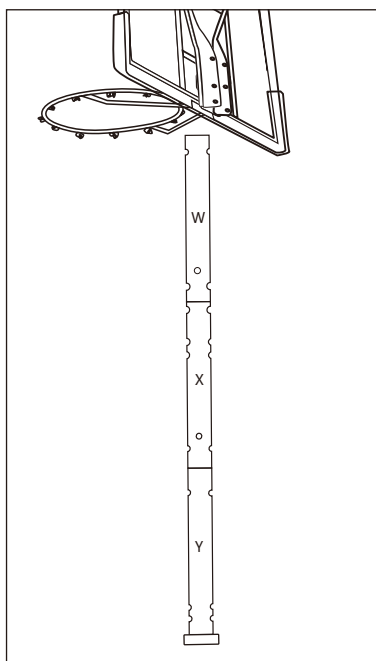

3.Adjustable height as shown in the figure:

