



Instructions  
Gebrauchsanleitung  
Instrucciones  
Istruizione

## PT100



pH (Phenol Red)  
Chlorine / Bromine  
(DPD1 / DPD3)

## PT500



pH (Phenol Red)  
Cl / Br (DPD1 / 3)  
Alk (Alkatest)

## PTM100



pH (Phenol Red)  
Chlorine / Bromine  
(DPD1 / DPD3)

Reagents  
Reagenzien  
Réactifs  
Reactivos  
Reagenti



**PT100 / PTM100:**  
DPD 1 RAPID (free chlorine)  
Phenol Red RAPID (pH)  
\*DPD 3 RAPID (total chlorine)  
\*optional!

**Refill-Pack:**  
TbsRD1pH60  
30 x Phenol Red RAPID  
30 x DPD 1 RAPID

Optional  
TbsRD350  
50 x DPD 3 RAPID

**PT500**  
DPD 1 RAPID (free chlorine)  
Phenol Red RAPID (pH)  
Alkatest RAPID (Alkalinity)  
\*DPD 3 RAPID (total chlorine)  
\*optional!

**Refill-Pack:**  
TbsRD1pHAL60  
20 x Phenol Red RAPID  
20 x DPD 1 RAPID  
20 x Alkatest RAPID

Optional  
TbsRD350  
50 x DPD 3 RAPID

**(GB)**

**CAUTION!**

Reagents for water-analysis only!  
Do not eat! Keep away from children!  
Store cool and dry!  
Clean tester properly before testing!

**(F)**

**Attention!**

Les pastilles sont exclusivement destinées aux analyses chimiques. NE PAS AVALER. Tenir hors de portée des enfants. Conserver dans un endroit frais et sec. Bien rincer le testeur avant chaque utilisation!

**(E)**

**¡Atención!**

Pastillas para el análisis de aguas, solamente para análisis químicos!  
No para tomar!  
No debe llegar a las manos de niños!  
Consérvese en lugar fresco y seco!  
Limpiar el aparato antes de usar!

**(I)**

**Attenzione!**

Reagenti unicamente per analisi acqua!  
Non ingerire!  
Tenere fuori dalla portata dei bambini!  
Mantenere in luogo asciutto e fresco  
Dopo l'utilizzo pulire ed asciugare accuratamente il tester.

**(P)**

**Atenção!**

Comprimidos para análise de água, apenas para a análise química!  
Não para tomar!  
Não deve chegar às mãos de crianças!  
Mantenha em local fresco e seco!  
Limpar o aparelho antes de usar!



**WATER TESTING**  
**MADE IN GERMANY**

1



2

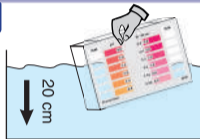

3

PT500  
1 x Alkalatest

Phenol Red  
1 x

DPD 1 (DPD3)  
1 x



Free Cl = 1 x DPD 1

Total Cl = 1x DPD 1 + 1 x DPD 3\*

plus 2 Min.

Combined Cl = Total Cl - Free Cl

\*optional

4

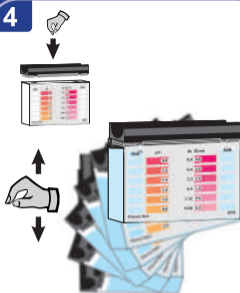

5

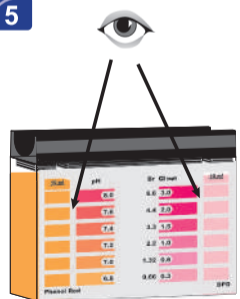

6



clean properly



no detergent!



**!!! Important !!!**

Very high chlorine levels  
will bleach out the DPD reagent  
and lead to colorless solution!

DPD RAPID tablets  
leave a white residue  
on the bottom of the tester.  
This is normal and does not  
interfere with the measurement

**PT500 / Alkalinity:**

conversion of Alkalinity to:

$K_{S,4.3}$  mmol/l (x 0.02)

°dH (x 0.056)

°eH (x 0.07)

°fH (x 0.1)